

ASSEMBLY INSTRUCTIONS

1. Mount the handle to the frame using the four $\frac{1}{4}$ " x $1\frac{3}{4}$ " carriage bolts. (Do not tighten)
2. Tool Box
 - a. Determine which bracket is left and which is right (they point toward the rear of the cart).
 - b. Mount one bracket on one side, place the toolbox on the pivot(s) mount the opposite side bracket.
3. Place wheels on axle with cotter pins and mount the axle with the 2 U-bolts on the back side of the frame and at the appropriate height (finger tighten).
4. Center the axle and tighten all bolts.

NOTE: Tires may be partially inflated.

If you have purchased a cart with pneumatic tires, please check tire pressures as you may find that the tire is under-inflated due to long term storage or valve stem seepage, simply fill to appropriate pressures after assembling cart. Should you receive your cart with a flat tire, please check the valve core – it may be too tight or too loose - remove, wipe clean and reinsert and inflate The tire and tube are standard sizes, available through your local hardware outlet.

We wish you many years of trouble-free service from this Ezee Roll Cart. Thank you for your business.

1. Handle (1)
2. Frame (1)
3. $\frac{1}{4}$ -20 x $1\frac{3}{4}$ Machine bolt (4)
4. $\frac{1}{4}$ "-20 x $\frac{3}{4}$ " U-Bolt (2)
5. $\frac{1}{4}$ "-20 Nut (12)
6. Left Hand Tool Box Bracket (1)
7. Right Hand Tool Box Bracket (1)
8. Tool Box (1)
9. Solid Axle (1)
10. Wheel Assembly (2)
11. Washer (2)
12. Cotter Pin (2)

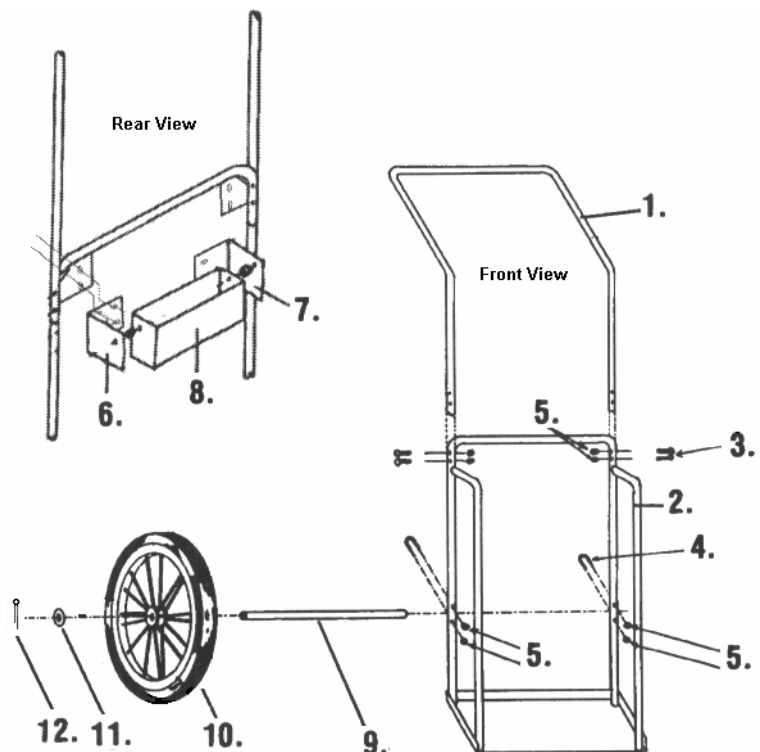

Manufactured with Pride



Manufacturing, Inc.

Phone: (217) 339-2279

Page: www.ezeeroll.com